

MAGNETONE

QUALITY DRIVEN . SERVICE - ORIENTED . CUSTOMER - FOCUSED

TECHNICAL INSTRUCTIONS - REFILLING OF DC-C400/450 TONER CARTRIDGE



STEP 1

Remove toner cartridge from machine.



STEP 2

Remove sealing tape from cartridge cap.



STEP 3

Pull out toner cap and dispose leftover "old" toner from cartridge.



MAGNETONE

QUALITY DRIVEN . SERVICE - ORIENTED . CUSTOMER - FOCUSED

TECHNICAL INSTRUCTIONS - REFILLING OF DC-C400/450 TONER CARTRIDGE

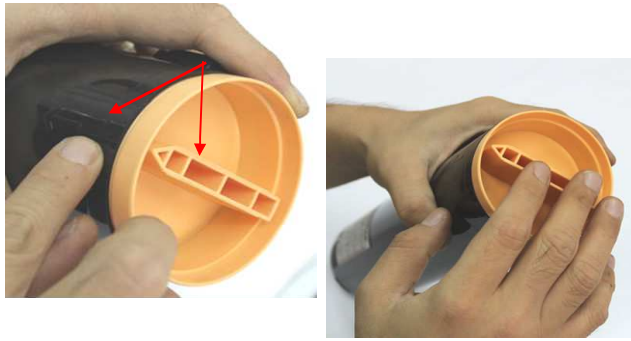

STEP 4

Refill with new compatible toner and attach toner cap. Ensure toner cap arrow is aligned with arrow on toner cartridge (as shown).

Clean toner cartridge exterior with Toner Wipes*.

* [Check out Magworks range of chemicals and accessories here.](#)



STEP 5

Apply black sealing tape round the toner cap.

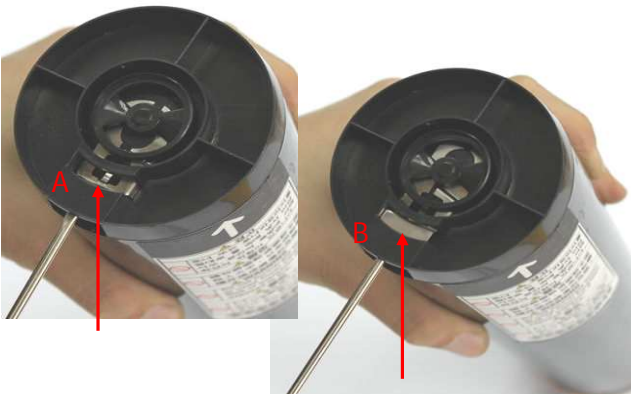

STEP 6

Locate metal slot (A) at the bottom of toner cartridge and push it gently with a flat screwdriver (B).

Cartridge is now ready to be installed.

